

With any medical test it is important that other factors do not interfere with your test result. Please read and follow these instructions carefully.

You must use the collection bottle provided by your doctor or SA Pathology.



Do not discard or touch any fluid or crystals in the bottle. Keep the lid on tight.

Medication and diet

Please tell your doctor if you are taking any medication. Some foods may interfere with the test.

Do not eat the following foods for *two days* before collecting your specimen: avocados, eggplant, bananas, plums, pineapple and *in particular walnuts*.

Collecting the specimen

Drink your normal amount of fluids during the 24 hour period.

Day 1

- when you get up (eg 7:30am) pass urine into the toilet
- *do not collect this specimen*
- write the *date, time, your name and date of birth* on the bottle label.

Collect ALL urine for 24 hours

- use a clean plastic container
- pour the urine into the collection bottle
- store the specimen in a cool place
- rinse the plastic container after each use.

Day 2

- at the *same time* as Day 1 (eg 7:30am)
- pass urine and collect it
- add it to the collection bottle
- write the *date and time* on the label.

Delivering the specimen

Deliver the specimen promptly to your nearest SA Pathology Patient Centre.

Your results

Your doctor will advise you when results are available.

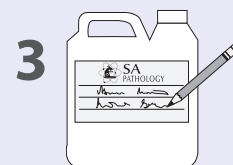
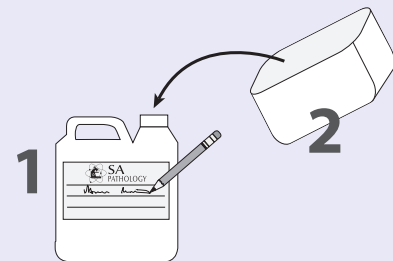

Patient Centres

For Patient Centre locations and latest opening hours visit our website www.sapathology.sa.gov.au or phone (08) 8222 3000.