

With any medical test it is important that other factors do not interfere with your test result. Please read and follow these instructions carefully.

You must use the collection bottle provided by your doctor or SA Pathology. Bottles can be collected from any SA Pathology Patient Centre.



Do not discard or touch any fluid or crystals in the bottle. Keep the lid on tight.

Collecting the specimen

Drink your normal amount of fluids during the 24 hour period.

Day 1

- When you get up (eg 7:30am) pass urine into the toilet.
- **Do not collect this specimen.**
- Write the date, time, your name and date of birth on the bottle label (1).

During the next 24 hours collect ALL urine

- Use a clean plastic container (rinse after each use).
- Pour the urine into the collection bottle (2).
- Store the specimen in a cool place.

Day 2

- Collect your first urine at the same time as Day 1 (eg 7:30am).
- Add it to the collection bottle, the test is now complete.
- Write the date and time on the label (3).

Delivering the specimen

Place the collection bottle into the ziploc plastic bag and then into the paper carry bag provided.

Deliver the specimen on the same day the test is complete to your nearest SA Pathology Patient Centre.

Your results

Your doctor will advise you when results are available.

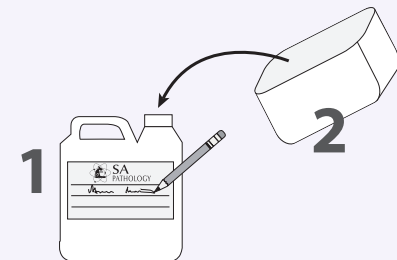

Patient Centres

For Patient Centre locations and latest opening hours visit our website www.sapathology.sa.gov.au or phone (08) 8222 3000.



This document has been reviewed and endorsed by SQCAG* for consumers and the community – August 2019.

*SA Health Safety and Quality Community Advisory Group